

## Drum Trolley

TRL-180H

Rugged build with outstanding features make these trolley ideal for use in workshops & industrial floors for transfer of large drums & buckets

Manufactured from heavy gauge 4 mm thick steel sheet for increased strength & durability

3" (75 mm) ground clearance for smooth movement over uneven surfaces in workshop environment

6" (150 mm) wide polyurethane front wheels with nylon rim for reduced wear & tear

Heavy duty rear castors with toe locks for higher safety & stability

### Available in 2 sizes

- Trolley for 50 kg / 120 lb. drums
- Trolley for 180 kg / 210 litre / 55 gal. drums. Can be used just as a trolley for safe movement of oil drums or a complete dispensing system with hose reel & pneumatic pump



CAT NR.	ORD NR.	SUITABLE FOR
TRL/180H	44431	180 kg / 55 gal. / 205 litre drums

## SAFETY INFORMATION

- Keep the work area clean and dry. Damp or wet work areas can result in injury.
- When not in use, tools and equipment should be stored in a dry location to inhibit rust and keep out of reach of children.
- Use the right tool for the job. Do not modify this equipment.
- Check for damaged parts. Before using this product, replace damaged or worn parts immediately.

## WARNING!

- Read carefully all the safety guidelines and the instructions.
- Failure to follow all instructions listed above may result in Improper functioning of pump and can cause serious injury

## PACKAGE CONTENT

DESCRIPTION	QUANTITY
Trolley Base	1
Handle	1
Carrier Assembly	1
O.I.P.M.	1

## INSTALLATIONS

1. Open the box to take out the Trolley sub assemblies



2. Unwrap the base (1)



3. Unscrew the 2 nuts and bolts attached on the base (1)



4. Tighten the carrier assembly (2) with the base (1) of the trolley using 2 nuts and bolts of 17mm (included in the pack)



5. Fix the handle (9) by inserting it into the handle slot and lock it by rotating the handle knob (6) in clockwise direction

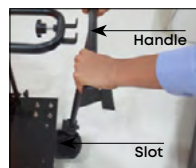

## MOUNTING THE DRUM ON TROLLEY

1. Handle (9) can be detached and used as a drum loader. Lift the drum by placing the handle in the position shown in the picture and slide the drum trolley beneath the drum simultaneously



2. Lock both the front castor wheel (5) by pressing it with foot



3. Lift the drum from other side and slide it over the trolley base till it reaches the extreme point on the base



4. Adjust the drum clamp (7) according to the height of the drum and rotate the knob in clockwise direction to lock the drum on the trolley

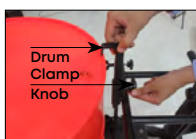

## MOUNTING THE PUMP OVER DRUM

1. Use drum wrench on the handle to open the drum cover



2. Insert the pump into the drum through the drum opening



3. While replacing the drum, pull the pump out of the drum and place it inside the drum clamp



## EXPLODED VIEW

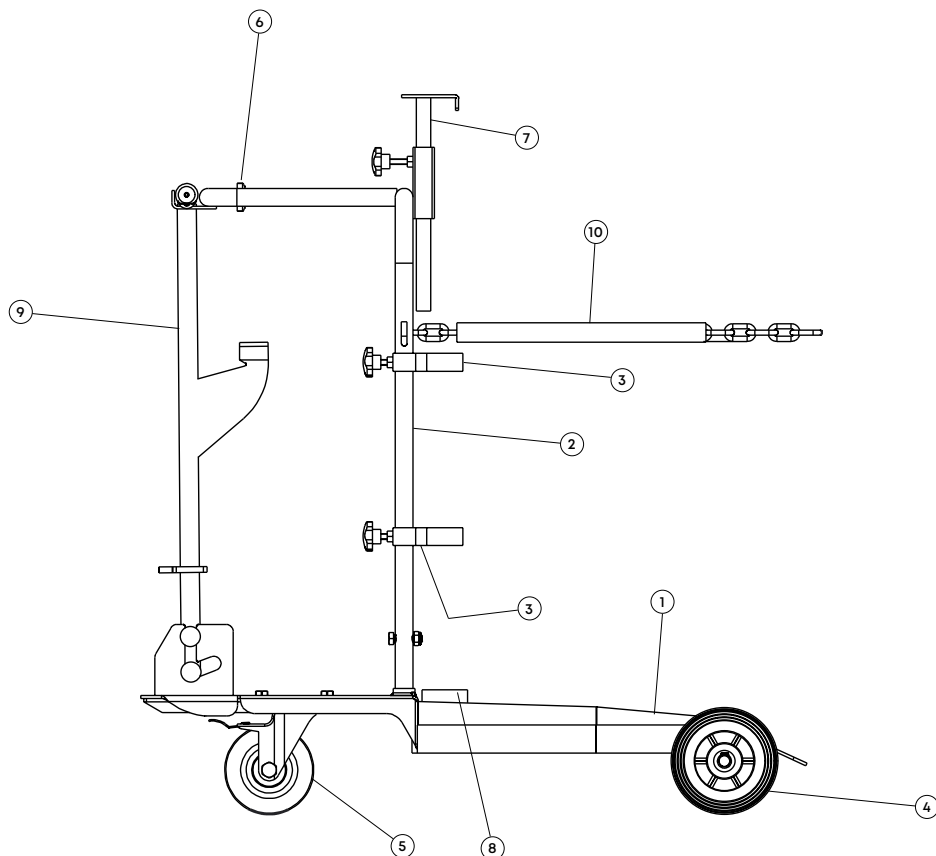

## PART LIST

REF. NR.	PARTS DESCRIPTION	QTY.
1	Base	1
2	Carrier Assembly	1
3	Pump Clamp	2
4	Wheel (Rear)	2
5	Castor Wheel	2

REF. NR.	PARTS DESCRIPTION	QTY.
6	Handle Knob	1
7	Drum Clamp	1
8	Cup	1
9	Handle	1
10	Chain with sleeve	1



## **GROZ WARRANTY POLICY**

Groz makes all efforts to ensure that its products meet the highest standards of quality and durability and warrants to the original purchaser its range of products for a period of 12 months from Groz Invoice date, against defects in materials and workmanship. If the Groz product is part of a set, only the portion that is defective is subject to this warranty.

This warranty does not apply to damage due directly or indirectly, to misuse, abuse, wear and tear, negligence or accident, repairs or alterations outside Groz plants, or to lack of maintenance. Groz shall in no event be liable for death, injuries to persons or property or for incidental, contingent, special or consequential damages arising from the use of its products. It is upto the user to determine suitability and safety of the product for their intended use, and the user assumes all risks and liability herewith.

In no event, shall Groz's liability exceed the invoiced cost of the product. In case of identification of defect covered under this warranty, the same must be notified in writing to Groz /Groz designated authorized service location. Proof of purchase date must accompany the complaint. Groz reserves the right to call back the faulty unit, all charges including transportation prepaid. On verification of the defect, the unit will be repaired or replaced with a new or reconditioned product or part of equal utility or a full refund given at Groz's discretion. The repaired /replaced units will be returned to the user freight prepaid, using most economical freight carrier. However if determined that the defect resulted from causes not within the scope of the warranty, then the cost of returning the product would be to buyer's account.

---

## **Groz Engineering Tools Pvt. Ltd. Groz Net Industries**

Village Kherki Daula, National Highway-8,  
Gurugram-122001, Haryana, INDIA

**Tel** +91.124.282.7700

**E-Mail** [info@groz-tools.com](mailto:info@groz-tools.com)

**Url** [www.groz-tools.com](http://www.groz-tools.com)

The GROZ name, GROZ logo and the  mark are trademarks of GROZ Engineering Tools Pvt. Ltd., India