

## Industrial Rotary Drum Pumps

RBP-3V



Industry Standard for Rotary Pumps

Ideal for tough outdoor use in extreme weather conditions

Solid cast iron construction, fully CNC machined to close tolerances

Pump Handle rotates a high quality sintered powder metal 3 vane rotor inside a highly finished pumping chamber

Self lubricating & non-wearing graphite vanes

High quality graphite seal allows the pump to be used with a wide variety of fluids including Diesel with upto 15% Ethanol blend

Self Priming operation with flow rate up to 38 LPM (10 GPM)

Supplied complete with 2" Bung, Telescopic Suction Tube with Strainer for use with 50-205 litre (15-55 gallon) drums

### WETTED COMPONENTS

Cast Iron, Steel, Graphite, Paper, Acetal, NBR

### DO NOT USE

With Water Based Media

### FLUIDS

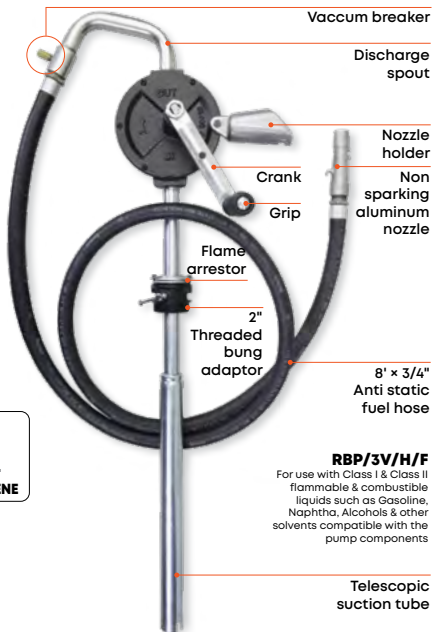
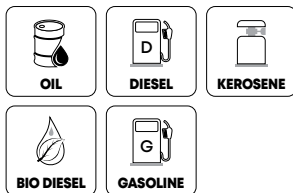

### RBP/3V/H/F

For use with Class I & Class II flammable & combustible liquids such as Gasoline, Naphtha, Alcohols & other solvents compatible with the pump components

### SPECIFICATIONS

CAT NR.	DESCRIPTION
RBP/3V	Steel Discharge Spout
RBP/3V/H	8' (1.8 m) Anti-Static Hose, Non-Sparking Aluminum Nozzle & Nozzle Holder
RBP/3V/H/MT	8' (1.8 m) Anti-Static Hose, Non Sparking Aluminium Nozzle, Nozzle Holder & Mechanical Fuel Meter (Litres)
RBP/3V/H/MTG	8' (1.8 m) Anti-Static Hose, Non Sparking Aluminium Nozzle, Nozzle Holder & Mechanical Fuel Meter (Gallons)

### FM APPROVED PUMPS

RBP/3V/F	Steel Discharge Spout, Drip Pan with Flame Arrestor
RBP/3V/H/F	8' (1.8 m) Anti-Static Hose, Non-Sparking Aluminum Nozzle & Nozzle Holder, Vacuum Breaker & Flame Arrestor
DP/RBP/3V	Replacement Drip Pan only

### SERVICE PARTS

KIT/RBP/3V	Repair Kit
SA/HOS/RBP/3V	8' (1.8 m) x 3/4" Replacement Hose

## SAFETY INFORMATION

- Follow workshop Health & Safety rules, regulations and conditions when using the rotary pump.
- Wear approved safety gloves and eye and ear protection.
- Maintain the rotary pump in good condition and replace any damaged or worn parts.
- Use genuine parts only. Unauthorized parts may be dangerous and will void the warranty.
- Keep the rotary pump clean and in good working order for best and safest performance.
- DO NOT use the rotary pump for a task it is not designed to perform.
- DO NOT drop, throw or abuse the rotary pump.
- When not in use, store the rotary pump in a safe, dry, childproof location

## WARNING!

- Read carefully all the safety guidelines and the instructions.
- Non-compliance with the safety rules and regulations can lead to serious injury.

## PACKAGE CONTENT

DESCRIPTION	QUANTITY
Pump Body	1
Handle	1
Hose	1
Bung Nut	1
Drip Pan	1
Telescopic Pipe	1
O.I.P.M.	1

## Note

Some parts are specific to the variants, refer specification table.

## ASSEMBLY & OPERATION

- Slide the bung onto the suction tube. Do not tighten the bung onto the suction tube, keep it loose.
- Screw the Telescopic Suction Tube into the female threads in the pump inlet. It is good practice to use a thread sealant such as PTFE when connecting the Telescopic Suction Tube to the Pump inlet. Tighten the connection securely to eliminate any air leaks.
- Extend the telescopic suction tube to its full length & insert the suction tube connected with the pump into the drum from the 2" threaded opening on the drum.

- Once the bottom of the suction tube touches the base of the drum, securely fasten the bung onto the drum.
- Now tighten the bung onto the suction tube securely.
- Screw the metallic discharge spout at the threaded outlet of the pump housing.
- Slide the crank already fitted with plastic grip over the pump shaft and tighten it using the hexagonal nut.
- Take an empty container & place it at the end of the hose / steel discharge spout. Start operating the pump handle which will allow the pump to get primed & start dispensing media in 7-10 strokes

## ASSEMBLY & OPERATION

### For RBP/3V/H & RBP/3V/H/F

- Assemble the rubber hose with the die cast dispensing nozzle onto one end of the hose. Assemble the other end onto the steel discharge spout
- Assemble the Nozzle Holder with the pump body. Remove the bolt from pump body, place nozzle holder at this specified location and re-tighten the hex bolt

## CAUTION!

- Always wear protection gear like safety goggles, gloves, apron, and ear plugs while operating the pump
- In case of accident, immediately seek medical attention. Do not try to treat the injury yourself
- Use only genuine factory parts for repair
- Do not smoke when using / near the pump
- Do not use the pump near a source of spark / open flames
- Make sure the pump and all other equipment used or located in the pumping area are grounded. Do not use pump if any static sparking or electrical shock occurs. Stop pumping immediately and do not use.
- In case of change of working fluid, at least 1 liter (or as desired) of new fluid should be discarded to avoid mixing of fluids
- Keep work area clean, uncluttered, and properly lighted, replace all unused tools & equipment.

## Note

Any pump used to transfer flammable liquids must be stored in a well ventilated area after use.

Use PTFE tape or proper sealant to secure joints  
Failure to follow all general safety information can result in a fatality, personal injury and/or property damage!

**EXPLODED VIEW**

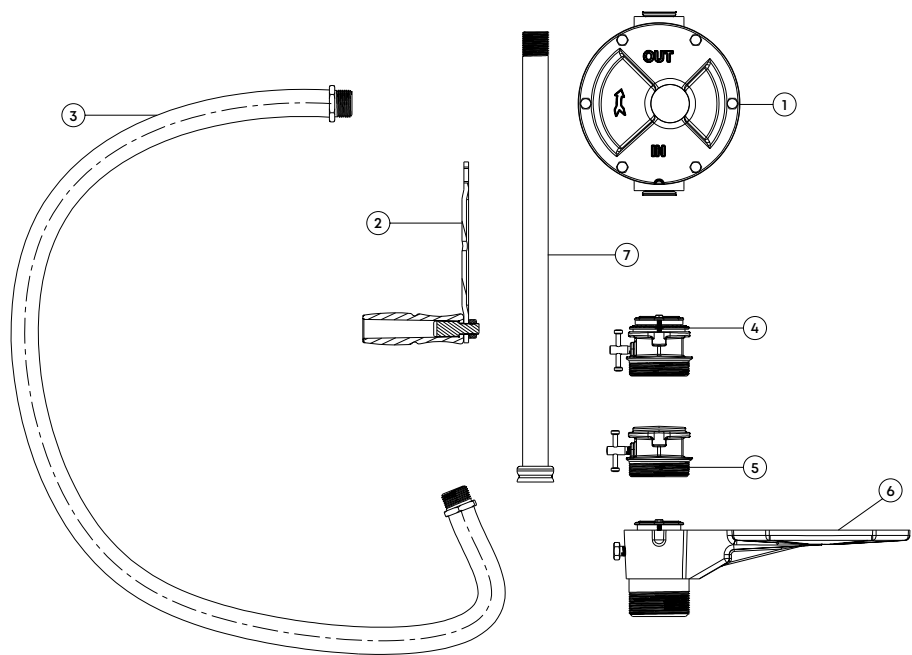

**PARTS LIST**

REF NO.	PARTS DESCRIPTION	QUANTITY
1	Pump Body	1
2	Handle	1
3	Hose	1
4	Bung Nut	1

REF NO.	PARTS DESCRIPTION	QUANTITY
5	Bung Nut, Spindle & Tommy bar Assy.	1
6	Drip Pan	1
7	Telescopic Pipe	1



## **GROZ WARRANTY POLICY**

Groz makes all efforts to ensure that its products meet the highest standards of quality and durability and warrants to the original purchaser its range of products for a period of 12 months from Groz Invoice date, against defects in materials and workmanship. If the Groz product is part of a set, only the portion that is defective is subject to this warranty.

This warranty does not apply to damage due directly or indirectly, to misuse, abuse, wear and tear, negligence or accident, repairs or alterations outside Groz plants, or to lack of maintenance. Groz shall in no event be liable for death, injuries to persons or property or for incidental, contingent, special or consequential damages arising from the use of its products. It is upto the user to determine suitability and safety of the product for their intended use, and the user assumes all risks and liability herewith.

In no event, shall Groz's liability exceed the invoiced cost of the product. In case of identification of defect covered under this warranty, the same must be notified in writing to Groz /Groz designated authorized service location. Proof of purchase date must accompany the complaint. Groz reserves the right to call back the faulty unit, all charges including transportation prepaid. On verification of the defect, the unit will be repaired or replaced with a new or reconditioned product or part of equal utility or a full refund given at Groz's discretion. The repaired /replaced units will be returned to the user freight prepaid, using most economical freight carrier. However if determined that the defect resulted from causes not within the scope of the warranty, then the cost of returning the product would be to buyer's account.

---

## **Groz Engineering Tools Pvt. Ltd. Groz Net Industries**

Village Kherki Daula, National Highway-8,  
Gurugram-122001, Haryana, INDIA

**Tel** +91.124.282.7700

**E-Mail** [info@groz-tools.com](mailto:info@groz-tools.com)

**Url** [www.groz-tools.com](http://www.groz-tools.com)

The GROZ name, GROZ logo and the  mark are trademarks of GROZ Engineering Tools Pvt. Ltd., India