

Plastic Rotary Pump

PRP/01/B

A special application pump designed for use with media that cannot be pumped using a regular cast-iron or steel pump.

Pump body is constructed using Polypropylene.

Vanes made out of Ryton

Built in strainer at inlet keeps contaminants away

Pump inlet & outlet threaded 3/4" (F)

Complete with 3 pc threaded suction tube for use on 50 Litre (15 gallon) to 205 Litre (55 gallon) drums.



FLOW RATE

**UPTO
5 LITERS (1.3GAL.)
PER 20 TURNS**

SPECIFICATIONS

CAT. NO.	PRP-01/B
BODY COLOUR	Yellow
ROTOR MATERIAL	Ryton
VANE MATERIAL	Ryton
HANDLE MATERIAL	Polypropylene
SHAFT SEAL	Viton
FASTENERS	Steel
DISCHARGE TUBE	Polypropylene
SUCTION TUBE (3 PCS.)	Polypropylene
STRAINER	Yes
NON RETURN VALVE	Yes
DUAL DIRECTION	No
BUNG NUT MATERIAL	Polypropylene
BUNG NUT DESCRIPTION	2" for metal drums
WETTED COMPONENTS	Polypropylene, Ryton, Viton, Steel, Stainless Steel 304 & LDPE
TYPICAL USE	Infrequent / Light Use
RECOMMENDED USE	Diesel, Antifreeze, Light Oils, & oil based media
DO NOT USE WITH	Acids, Chemicals, Solvents etc.

SAFETY INFORMATION

- Follow workshop Health & Safety rules, regulations and conditions when using the rotary pump.
- Maintain the rotary pump in good condition and replace any damaged or worn parts.
- Use genuine parts only. Unauthorised parts may be dangerous and will void the warranty.
- Wear approved safety gloves and eye and ear protection.
- Keep the rotary pump clean and in good working order for best and safest performance.
- DO NOT use the rotary pump for a task it is not designed to perform.
- DO NOT drop, throw or abuse the rotary pump.
- When not in use, store the rotary pump in a safe, dry, childproof location.

WARNING!

- Read and understand all instructions. Failure to follow all instructions listed above may result in serious injury.

PACKAGE CONTENT

DESCRIPTION	QUANTITY
Pump body	1
Pump handle (Crank & handle with nut)	2
Bung nut	1
Discharge spout (2 piece)	1 set
Suction tube (3 piece)	1 set
O.I.P.M.	1

TOOLS NEEDED

- 14 mm spanner / 9/16" spanner
- 15 mm spanner

BEFORE INSTALLATION

- Eyes protection:** Wear a protective mask or protective eyewear.
- Skin protection:** Avoid repeated and prolonged contact of fluids with the skin by wearing impermeable protective gloves.
- Check that the equipment has not suffered any damage during transport or storage. Clean the inlet and outlet openings, removing any dust or residual packing material.
- Read the instructions carefully before using the pump and keep them for further reference.

INSTALLATION

(Refer "EXPLODED VIEW")

- Assemble the two parts (a, b) of the discharge spout (10) together & fasten the assembly onto the outlet on the main pump body (1)
- Thread tighten the pump handle (14) onto the crank (16) & connect the crank (16) to the crankshaft (2) on the pump body (1).

- Secure the connection using the bolt (13) provided. Make sure that the bolt (13) fits onto the depression in the crankshaft (2).
- Slide the bung nut (7) onto the suction tube (6) from the top end & tighten the suction tube (6) onto the inlet on the main pump body (1)
- The suction tube part (6) with the strainer may be connected direct onto the pump inlet or assembled with one extension or both extensions, depending upon drum size. All three parts of suction tube (6) must be connected for use with 55 gallon / 205 litre drums. Use sealant in connecting the suction tube parts (6) for a totally leak-proof connection.
- Insert the pump assembly into the drum from the 2" drum opening.
- Once the bottom of the suction tube (6) touches the base of the drum, securely fasten the bung nut (7) onto the drum. Now very lightly tighten the bung nut (7) onto the suction tube (6).

OPERATING INSTRUCTIONS

(Refer "EXPLODED VIEW")

- Take an empty container & place it below the discharge spout (10 or 11). Start rotating pump handle (14). Within a maximum of seven rotations, pump will be primed & will start dispensing media.
- In a rare case, where the pump does not get primed, the same can be done by reversing the outlet discharge spout (10 or 11) on the pump & pouring about 30 ml of oil into the outlet & operating the pump handle (14) for about seven rotations.
- The pump is now ready to use.
- Once the pumping is completed, it is advised to invert the discharge spout (10 or 11) sideways for a non-drip operation.

CAUTION!

- If the pump is re-used after a long time, it may lose it's prime & need re-priming.

MAINTENANCE

(Refer "EXPLODED VIEW")

- This pump required little maintenance, however to maximize the useful life of the pump it is recommended to inspect and, if necessary, periodically clean the suction tube (6)

EXPLODED VIEW

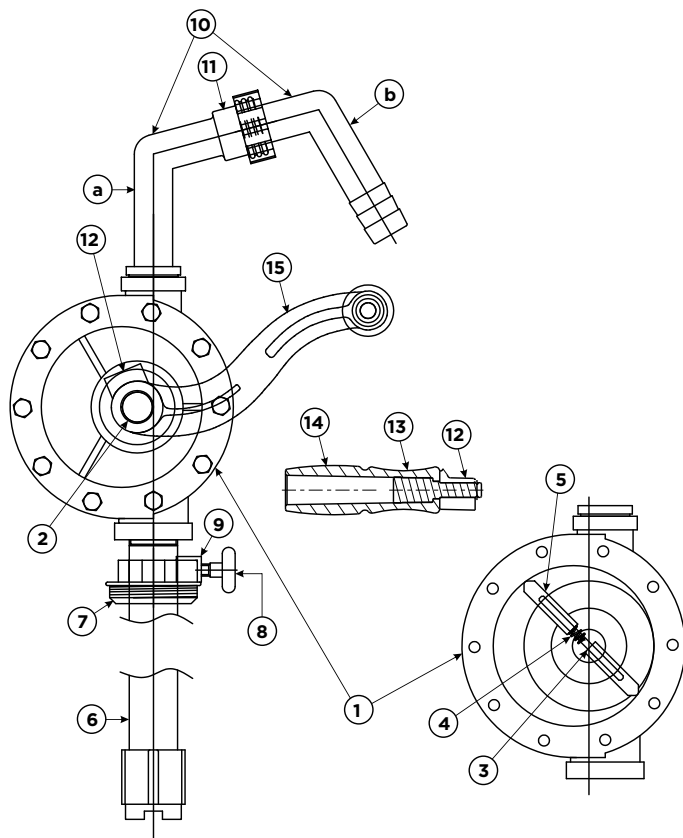

PARTS LIST

REF NO.	PARTS DESCRIPTION	QUANTITY
1	Pump body	1
2	Crankshaft	1
3	Pin	1
4	Spring	1
5	Vane	2
6	Suction Tube (3 Piece)	1 Set
7	Bung nut	1
8	Knob	1
9	Locking clip	1

REF NO.	PARTS DESCRIPTION	QUANTITY
10	Discharge Spout (2 Piece)**	1 Set
a.	• Outlet pipe	1
b.	• Elbow	1
11	Cap	1
12	Bolt (Handle grip)	2
13	Pump handle	1
14	Handle grip	1
15	Crank	1

TROUBLESHOOTING

PROBLEM	POSSIBLE CAUSE	CORRECTIVE ACTION
Pump does not dispense fluid	Pump not able to create adequate suction	Prime the pump. Refer "OPERATING INSTRUCTIONS"
	Pump is drawing in air, instead of fluid	Tighten all connections of suction tube & of the suction tube with pump inlet
	Suction tube inlet is blocked	Remove suction tube & clean strainer at tube inlet
Leakage of media from the crankshaft	Damaged seal due to use with media not suitable for use with pump	Replace seal with genuine replacement seal from manufacturer
Tight handle movement	Pump has not been used for a long time	Remove pump cover and inspect for deposits on components and corroded parts. Clean or replace parts. Flush pump with the media being used if pump is not in use for a long period.
	Damaged or worn pump parts	Remove pump cover & inspect internal parts. Replace worn or damaged parts

DISPOSAL

The components or the used product must be given to companies that specialize in the disposal and recycling of industrial waste.

GROZ WARRANTY POLICY

Groz makes all efforts to ensure that its products meet the highest standards of quality and durability and warrants to the original purchaser its range of products for a period of 12 months from Groz Invoice date, against defects in materials and workmanship. If the Groz product is part of a set, only the portion that is defective is subject to this warranty.

This warranty does not apply to damage due directly or indirectly, to misuse, abuse, wear and tear, negligence or accident, repairs or alterations outside Groz plants, or to lack of maintenance. Groz shall in no event be liable for death, injuries to persons or property or for incidental, contingent, special or consequential damages arising from the use of its products. It is upto the user to determine suitability and safety of the product for their intended use, and the user assumes all risks and liability herewith.

In no event, shall Groz's liability exceed the invoiced cost of the product. In case of identification of defect covered under this warranty, the same must be notified in writing to Groz /Groz designated authorized service location. Proof of purchase date must accompany the complaint. Groz reserves the right to call back the faulty unit, all charges including transportation prepaid. On verification of the defect, the unit will be repaired or replaced with a new or reconditioned product or part of equal utility or a full refund given at Groz's discretion. The repaired /replaced units will be returned to the user freight prepaid, using most economical freight carrier. However if determined that the defect resulted from causes not within the scope of the warranty, then the cost of returning the product would be to buyer's account.

Groz Engineering Tools (P) Ltd. Groz Net Industries

Village Kherki Daula, National Highway-8,
Gurugram-122001, Haryana, INDIA

Tel +91.124.282.7734/40, 2827777

Fax +91.124.2827980, 2827986

E-Mail info@groz-tools.com

Url www.groz-tools.com

The GROZ name, GROZ logo and the  mark are trademarks of GROZ Engineering Tools (P) Ltd., India