

### Electric Oil & Fuel Pumps

EOP



Vertical mount Oil & Fuel pump

Designed for light industrial, automotive, heating & marine applications

For use with non-flammable media

Built-in bung adapter fits directly on drums with 2" threaded opening

Manufactured from

chemically inert materials, pumps work with a wide variety of low viscosity media

Motor has double insulation making it safe for use with water & emulsions

Built-in anti-siphoning system ensures that media does not flow out by siphon action causing accidental damage to the delivery



hose or dispensing nozzle

**Duty Cycle**  
Continuous Duty

### SPECIFICATIONS

	EOP/DC/12	EOP/DC/24	EOP/AC/110	EOP/AC/230
Description	12V DC	24V DC	110V AC, 60 Hz	230V AC, 50 Hz
Flow rate*	UPTO 35 LPM (9.25 GPM)	UPTO 35 LPM (9.25 GPM)	UPTO 40 LPM (10.5 GPM)	UPTO 40 LPM (10.5 GPM)
Motor	0.43 HP Centrifugal Motor	0.43 HP Centrifugal Motor	0.43 HP Centrifugal Motor	0.43 HP Centrifugal Motor
Amp	9.2 Amp	5.6 Amp	2.9 Amp	1 Amp
Absorbed Power	110 W	135 W	320 W	224 W
Internal Bypass Valve	No	No	No	No
Discharge Head	1 Meter	1 Meter	1 Meter	1 Meter
TELESCOPIC Suction TUBE	Extends from 31-1/2" to 43-45/64" (800 mm to 1110 mm)			
Delivery Hose	3/4" ID x 2.5M Long			
Tank Adaptor outlet	2" & M64 x 4 3/4" HB			
Dispensing Nozzle	Manual Polypropylene nozzle with 3/4" Hose Barb			
Battery/Power Cable	3m long with battery clamps		2m long with US plug	2m long with EU plug
Water/ Dust Protection	IP X 4 ( protection against splashing water)			
Noise Level	70 db			

\*Measured at pump outlet tested using Diesel

CAT NR.	ORD NR.	DESCRIPTION
EOP/DC/12	45521	12V DC
EOP/DC/24	45523	24V DC
EOP/AC/110	45522	110V AC
EOP/AC/230	45520	230V AC

### FLUIDS



### WARNING

**DO NOT USE**  
With fluids with a flash point below 100°F (38°C), such as Gasoline & Alcohol

Sparking could result in explosion causing fatal injury

## SAFETY INFORMATION

- The motor and switch are not of an anti-explosive type. Do not use the pump in areas where there is risk of explosion
- Do not use the pump for gasoline, inflammable liquids with PM < 55° C, Food Liquids, Corrosive Chemical Products and Solvents
- Do not smoke or use open flame during refuelling
- Avoid spilling diesel, which is harmful to the environment
- Never operate the pump when empty
- Do not leave the motor running under delivery in closed condition (i.e when the Trigger (5) is not pressed) for more than five minutes
- The pump only works in vertical position
- The pump must only be used under the surveillance of the operator
- Before connecting the pump to the power supply, ensure that the voltage complies with the limitations indicated
- Power that is out of specified limits can damage the electrical components
- Max. acceptable variation =  $\pm 5\%$  of the nominal value

## PACKAGE CONTENT

DESCRIPTION	QUANTITY
Pump Body	1
2.5 meter $\times$ 3/4" rubber hose (to be cut as required)	1
Dispensing Nozzle [including trigger (8)]	1
Hose Clamps	2
Telescopic Suction Tube	1
O.I.P.M.	1

## TOOLS NEEDED

Phillips Screwdriver PH1

## INSTALLATION

1. Fasten the telescopic suction tube to the motor



2. Screw the pump body (1) onto the drum or tank, taking care to place the pump in a vertical position



3. Assemble the delivery hose (2) onto the delivery port of the pump body and fasten it with a hose clamp (3)



4. Assemble the dispensing nozzle (4) onto the opposite end of the delivery hose (2) and fasten in place with a hose clamp (3)



5. Now connect the pump to the power source

## OPERATION

1. Priming Procedure: Open the nozzle by pressing the trigger (5). Start the pump by repeatedly activating the lever (6) until the liquid starts flowing from the dispensing nozzle.
2. When fluid starts flowing out, start the motor using the switch (9) and proceed to fuelling.
3. When finished, release the Trigger (5) and switch off (1) the motor.

## WARNING!

The operator must repeat "Priming Procedure" under the following situations:

- After an extended stop
- If liquid does not flow
- If the motor is re-started
- After a power failure

## EMERGENCY OPERATION

In the case of power failure or when small quantities of liquid need to be transferred, it is possible to operate the pump manually, in the following manner:

- Keep the trigger (5) of the dispensing nozzle pressed
- Activate the lever (6) repeatedly till liquid starts flowing out of the nozzle

## DISASSEMBLY AND MAINTENANCE

This pump requires little maintenance, but we recommend the periodic inspection, and if necessary cleaning of the intake filter, and the state of efficiency of the hoses and the dispensing nozzle, in order to ensure a long working life.

If the electric cable is damaged it must be replaced by a technically qualified person so as to prevent any risk.

Make sure that the place where the pump is installed is not susceptible to being overflowed.

## EXPLODED VIEW

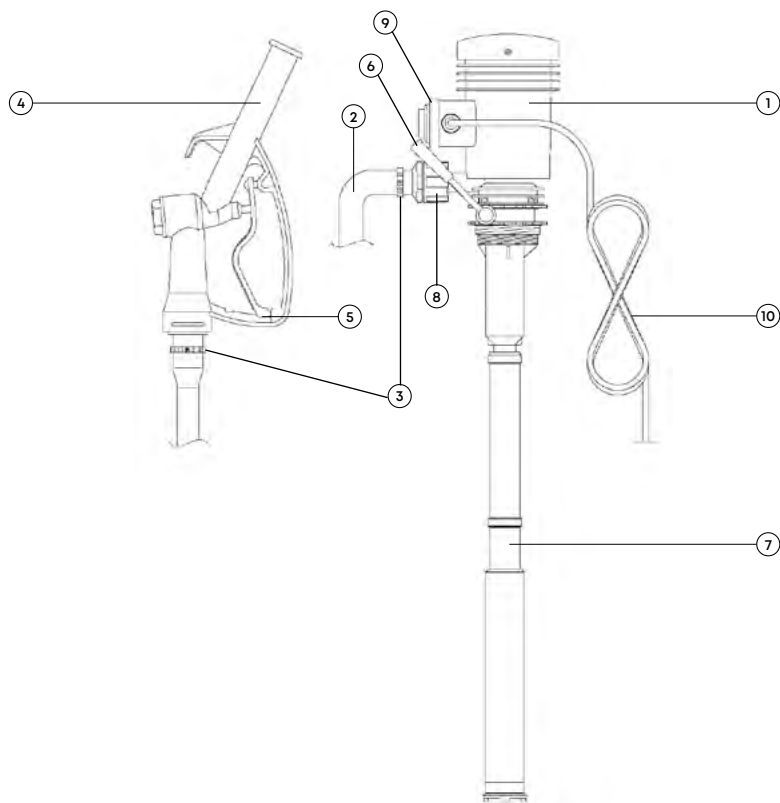

## PARTS LIST

REF NO.	PARTS DESCRIPTION	QUANTITY
1	Pump Body	1
2	2.5 meter 3/4" Rubber hose	1
3	Hose Clamps	2
4	Dispensing Nozzle	1
5	Trigger	1

REF NO.	PARTS DESCRIPTION	QUANTITY
6	Lever	1
7	Telescopic Suction Tube	1
8	Locking Ring	1
9	ON/OFF Switch	1
10	Power Cable	1



#### TROUBLESHOOTING

PROBLEM	CAUSE	SOLUTION
The motor is not turning	Lack of electric power	Check the electrical connections and safety systems. Contact the Service Department
The pump is not primed	Probable emptying of the intake tube	Prime according to the described procedure.

#### GROZ WARRANTY POLICY

Groz makes all efforts to ensure that its products meet the highest standards of quality and durability and warrants to the original purchaser its range of products for a period of 12 months from Groz Invoice date, against defects in materials and workmanship. If the Groz product is part of a set, only the portion that is defective is subject to this warranty.

This warranty does not apply to damage due directly or indirectly, to misuse, abuse, wear and tear, negligence or accident, repairs or alterations outside Groz plants, or to lack of maintenance. Groz shall in no event be liable for death, injuries to persons or property or for incidental, contingent, special or consequential damages arising from the use of its products. It is upto the user to determine suitability and safety of the product for their intended use, and the user assumes all risks and liability herewith.

In no event, shall Groz's liability exceed the invoiced cost of the product. In case of identification of defect covered under this warranty, the same must be notified in writing to Groz /Groz designated authorized service location. Proof of purchase date must accompany the complaint. Groz reserves the right to call back the faulty unit, all charges including transportation prepaid. On verification of the defect, the unit will be repaired or replaced with a new or reconditioned product or part of equal utility or a full refund given at Groz's discretion. The repaired /replaced units will be returned to the user freight prepaid, using most economical freight carrier. However if determined that the defect resulted from causes not within the scope of the warranty, then the cost of returning the product would be to buyer's account.

#### Groz Engineering Tools Pvt. Ltd. Groz Net Industries

Village Kherki Daula, National Highway-8,  
Gurugram-122001, Haryana, INDIA

**Tel** +91.124.282.7700

**E-Mail** info@groz-tools.com

**Url** www.groz-tools.com

The GROZ name, GROZ logo and the  mark are trademarks of GROZ Engineering Tools Pvt. Ltd., India