

Oil Lube Dispensers

BLP



Pump designed for transferring transmission differentials & heavier oils

Zinc plated pump body with aluminium die cast head & adjusting flange

Powder coated steel drum cover

Wear resistant brass piston rings fitted onto zinc die cast piston

Complete with 48"/4' fuel resistant soft PVC hose with nozzle for efficient discharge

Also available complete with steel drum

WETTED COMPONENTS

Steel, Aluminum, Zinc, Brass, NBR, PVC

RECOMMENDED USE

Engine Oils, Transmission, Differentials & Heavier Oils

DO NOT USE with

Water based & other corrosive media



SPECIFICATIONS

CAT NR.	DRUM CAPACITY		
	(LBS)	(LITRES)	(GAL.)
BLP SERIES			
BLP/02	35	20	5
BLP/03	120	60	16

	BLP-02	BLP-03
Discharge Rate	Up to 60 ml (2.14 oz.) per stroke	
Mechanism	Lever Action	
Hose Length	48"	
Container Size	25-50 lbs / 5 Gal / 20 Litres	120 lbs / 16 Gal / 60 Litres
Drum Cover Dia.	12" (310 mm)	15" (381 mm)
Pump Length	18" (450 mm)	30" (760 mm)

SAFETY INFORMATION

- Keep the work area clean and dry. Damp or wet work areas can result in injury.
- When not in use, tools and equipment should be stored in a dry location to inhibit rust and keep out of reach of children.
- Use the right tool for the job. Do not modify this equipment.
- Check for damaged parts. Before using this product, replace damaged or worn parts immediately.

WARNING!

- Read carefully all the safety guidelines and the instructions.
- Failure to follow all instructions listed above may result in Improper functioning of pump and can cause serious injury.

PACKAGE CONTENT

DESCRIPTION	QUANTITY
Vinyl Hose (with Adaptor, Clamp, Steel Spout)	1
Pump tube assembly	1
Lever Handle	1
Drum Cover	1
O.I.P.M.	1

ASSEMBLY & OPERATION

1. Place the drum cover assembly over the container. Hand tighten the three thumb screws evenly onto the drum cover assembly to fix the drum cover firmly onto the container.
2. Pull the plunger rod of piston sub assembly up. Attach the lever handle to the piston rod using the pivot pin and retainer clip.
3. Push the pump tube assembly down through the die cast flange of the drum cover until the pump tube rests onto the base of the container. Ensure that the tube assembly touches the base of the container.
4. Tighten the machine screw and the hex nut in the flange assembly to hold the pump assembly firmly in place. Do not over tighten the screw and nut.
5. Screw the adapter onto the pump outlet. Do not over tighten. Use a thread sealant to prevent leakage.
6. Screw the hose assembly onto the outlet end of the adapter.
7. Now the pump is ready. Start the pump by moving the lever handle. Priming is a process of getting the pump started by operating the pump a few times. If there is any difficulty in Priming, put some oil in the pump outlet and keep operating the lever handle until the discharge begins.

8. Pierce open a hole on the drum cover using a pin punch. When the pump is not in use, place the hose assembly into this hole.

WARNING!

- The pump is constructed using plated steel components. It should never be used to transfer fluids that may cause the pump to rust.
- Keep work area clean and remove any excess oil from tools, hands, and clothing after use.

EXPLODED VIEW

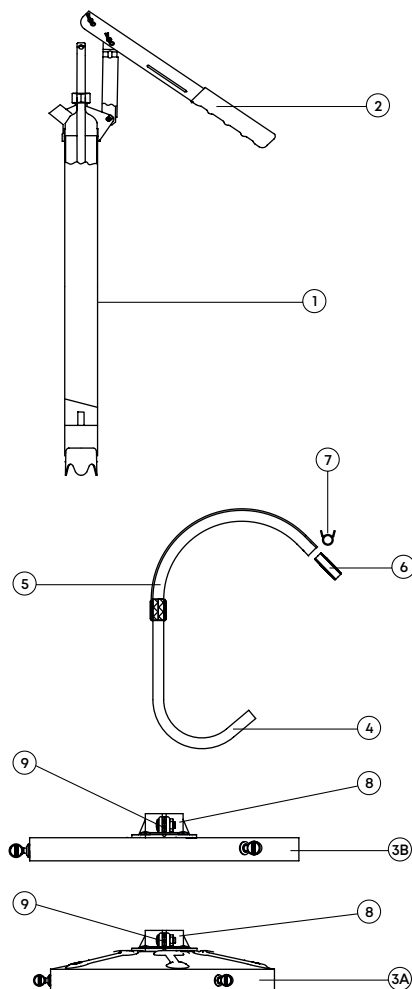

PART LIST

REF NO.	PARTS DESCRIPTION	QUANTITY
1	Pump Tube Assembly	1
2	Lever Handle	1
3	Drum Cover	1
(a)	BLP-02	
(b)	BLP-03	
4	Delivery Spout	1

REF NO.	PARTS DESCRIPTION	QUANTITY
5	Hose	1
6	Adaptor	1
7	Clamp	1
8	Flange	1
9	Screw	1

TROUBLESHOOTING

(Refer "EXPLODED VIEW")

PROBLEM	CAUSE	SOLUTION
Pump does not dispense the fluid	Pump fails to prime	Pour a few drops of the fluid being dispensed into the pump outlet. Start the pump by moving the lever with several quick strokes.
	Blockage in the suction line	Remove the pump from the drum and ensure that suction tube & non-return valve is free of any blockage.

DISPOSAL

The components or the used products must be given to companies that specialize in the disposal and recycling of industrial waste.



GROZ WARRANTY POLICY

Groz makes all efforts to ensure that its products meet the highest standards of quality and durability and warrants to the original purchaser its range of products for a period of 12 months from Groz Invoice date, against defects in materials and workmanship. If the Groz product is part of a set, only the portion that is defective is subject to this warranty.

This warranty does not apply to damage due directly or indirectly, to misuse, abuse, wear and tear, negligence or accident, repairs or alterations outside Groz plants, or to lack of maintenance. Groz shall in no event be liable for death, injuries to persons or property or for incidental, contingent, special or consequential damages arising from the use of its products. It is upto the user to determine suitability and safety of the product for their intended use, and the user assumes all risks and liability herewith.

In no event, shall Groz's liability exceed the invoiced cost of the product. In case of identification of defect covered under this warranty, the same must be notified in writing to Groz /Groz designated authorized service location. Proof of purchase date must accompany the complaint. Groz reserves the right to call back the faulty unit, all charges including transportation prepaid. On verification of the defect, the unit will be repaired or replaced with a new or reconditioned product or part of equal utility or a full refund given at Groz's discretion. The repaired /replaced units will be returned to the user freight prepaid, using most economical freight carrier. However if determined that the defect resulted from causes not within the scope of the warranty, then the cost of returning the product would be to buyer's account.

Groz Engineering Tools Pvt. Ltd. Groz Net Industries

Village Kherki Daula, National Highway-8,
Gurugram-122001, Haryana, INDIA

Tel +91.124.282.7700

E-Mail info@groz-tools.com

Url www.groz-tools.com

The GROZ name, GROZ logo and the  mark are trademarks of GROZ Engineering Tools Pvt. Ltd., India